

KB TYPE

– Standard Type –

This type is a metric dimension series generally used in Europe.

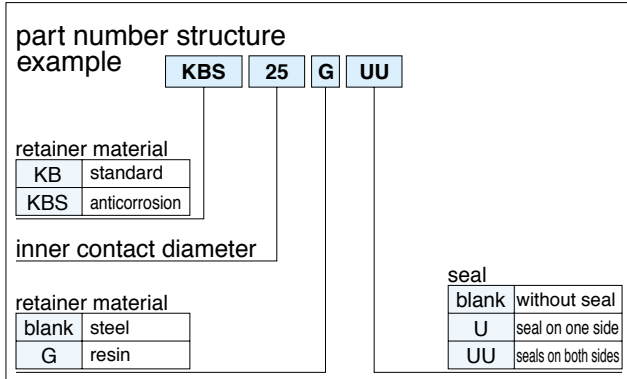

| part number | | | | number of ball circuits | dr | | | |
|----------------|----------------|--------------------|----------------|-------------------------|----|-------------------------|-----|-------------------------|
| standard | | anticorrosion | | | mm | tolerance μm | D | |
| steel retainer | resin retainer | stainless retainer | resin retainer | | | | mm | tolerance μm |
| KB 3 | KB 3G | KBS 3 | KBS 3G | 4 | 3 | + 8 0 | 7 | 0 - 8 |
| KB 4 | KB 4G | KBS 4 | KBS 4G | 4 | 4 | | 8 | |
| KB 5 | KB 5G | KBS 5 | KBS 5G | 4 | 5 | | 12 | |
| KB 8 | KB 8G | KBS 8 | KBS 8G | 4 | 8 | | 16 | |
| KB10 | KB10G | KBS10 | KBS10G | 4 | 10 | + 9 | 19 | 0 - 9 |
| KB12 | KB12G | KBS12 | KBS12G | 4 | 12 | | 22 | |
| KB16 | KB16G | KBS16 | KBS16G | 4 | 16 | - 1 | 26 | 0 - 11 |
| KB20 | KB20G | KBS20 | KBS20G | 5 | 20 | | 32 | |
| KB25 | KB25G | KBS25 | KBS25G | 6 | 25 | +11 | 40 | - 13 |
| KB30 | KB30G | KBS30 | KBS30G | 6 | 30 | - 1 | 47 | |
| KB40 | KB40G | KBS40 | KBS40G | 6 | 40 | +13 - 2 | 62 | 0 - 13 |
| KB50 | KB50G | KBS50 | KBS50G | 6 | 50 | | 75 | |
| KB60 | KB60G | KBS60 | KBS60G | 6 | 60 | +16/-4 | 90 | 0 - 15 |
| KB80 | — | — | — | 6 | 80 | | 120 | |



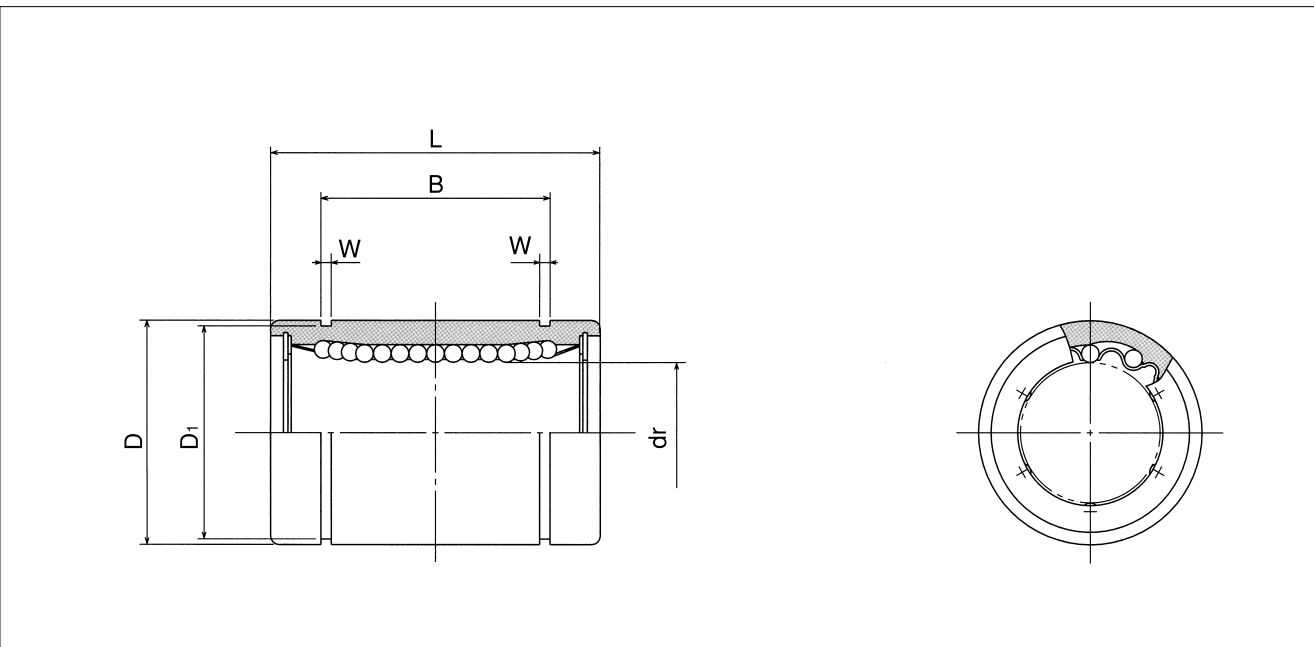

| major dimensions | | | | | | eccentricity μm | radial clearance (maximum) μm | basic load rating | | mass g | shaft diameter mm | |
|------------------|-----------------|-------|-----------------|-------|----------------|-------------------------------|---|-------------------|-------------------------------|-----------|-------------------------|----|
| mm | L | B | | W | D ₁ | | | dynamic C N | static C ₀ N | | | |
| | tolerance mm | mm | tolerance mm | | | | | | | | | mm |
| 10 | 0 | — | — | — | — | 10 | — 3 | 69 | 105 | 1.4 | 3 | |
| 12 | -0.12 | — | — | — | — | | | 88 | 127 | 2 | 4 | |
| 22 | 0 | 14.5 | 0 | 1.1 | 11.5 | | | 12 | — 4 | 206 | 265 | 11 |
| 25 | | 16.5 | | 1.1 | 15.2 | 265 | 402 | | | 22 | 8 | |
| 29 | | 22 | | 1.3 | 18 | 372 | 549 | | | 36 | 10 | |
| 32 | | -0.2 | | 22.9 | 1.3 | 21 | 510 | | | 784 | 45 | 12 |
| 36 | | 24.9 | | 1.3 | 24.9 | 578 | 892 | | | 60 | 16 | |
| 45 | 0 | 31.5 | 0 | 1.6 | 30.3 | 15 | — 6 | 862 | 1,370 | 102 | 20 | |
| 58 | | 44.1 | | 1.85 | 37.5 | | | 980 | 1,570 | 235 | 25 | |
| 68 | | 52.1 | | 1.85 | 44.5 | | | 1,570 | 2,740 | 360 | 30 | |
| 80 | -0.3 | 60.6 | -0.3 | 2.15 | 59 | 17 | — 8 | 2,160 | 4,020 | 770 | 40 | |
| 100 | 77.6 | 2.65 | 72 | 3,820 | 7,940 | | | 1,250 | 50 | | | |
| 125 | 0 | 101.7 | 0 | 3.15 | 86.5 | 20 | -13 | 4,700 | 9,800 | 2,220 | 60 | |
| 165 | -0.4 | 133.7 | -0.4 | 4.15 | 116 | | | -20 | 7,350 | 16,000 | 5,140 | 80 |

1N \approx 0.102kgf



KB-AJ TYPE

– Clearance Adjustable Type –

This type is a metric dimension series generally used in Europe.

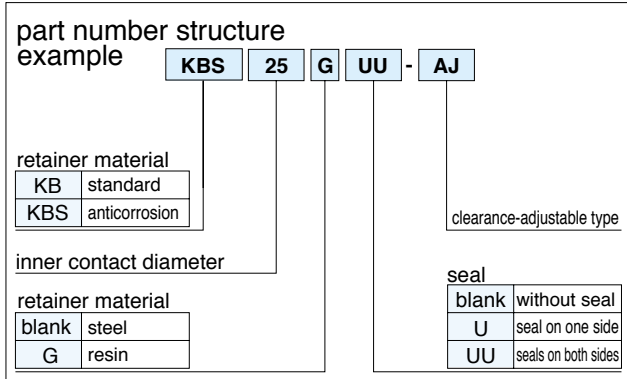

| part number | | | | number of ball circuits | D | | | |
|----------------|-----------------|--------------------|------------------|-------------------------|----|------------------|-----------|------------------|
| standard | | anticorrosion | | | dr | | D | |
| steel retainer | resin retainer | stainless retainer | resin retainer | | mm | tolerance* μm | mm | tolerance* μm |
| — | KB 5G-AJ | — | KBS 5G-AJ | 4 | 5 | + 8 0 | 12 | 0 |
| — | KB 8G-AJ | — | KBS 8G-AJ | 4 | 8 | | 16 | - 8 |
| — | KB10G-AJ | — | KBS10G-AJ | 4 | 10 | | 19 | 0 |
| KB12-AJ | KB12G-AJ | KBS12-AJ | KBS12G-AJ | 4 | 12 | + 9 - 1 | 22 | - 9 |
| KB16-AJ | KB16G-AJ | KBS16-AJ | KBS16G-AJ | 4 | 16 | | 26 | 0 - 11 |
| KB20-AJ | KB20G-AJ | KBS20-AJ | KBS20G-AJ | 5 | 20 | | 32 | |
| KB25-AJ | KB25G-AJ | KBS25-AJ | KBS25G-AJ | 6 | 25 | 40 | 0 - 13 | |
| KB30-AJ | KB30G-AJ | KBS30-AJ | KBS30G-AJ | 6 | 30 | 47 | | |
| KB40-AJ | KB40G-AJ | KBS40-AJ | KBS40G-AJ | 6 | 40 | 62 | | 0 |
| KB50-AJ | KB50G-AJ | KBS50-AJ | KBS50G-AJ | 6 | 50 | + 13 - 2 | 75 | - 13 |
| KB60-AJ | KB60G-AJ | KBS60-AJ | KBS60G-AJ | 6 | 60 | | 90 | 0 |
| KB80-AJ | — | — | — | 6 | 80 | | + 16/- 4 | 120 |

* Accuracy is measured prior to machining clearance slot.

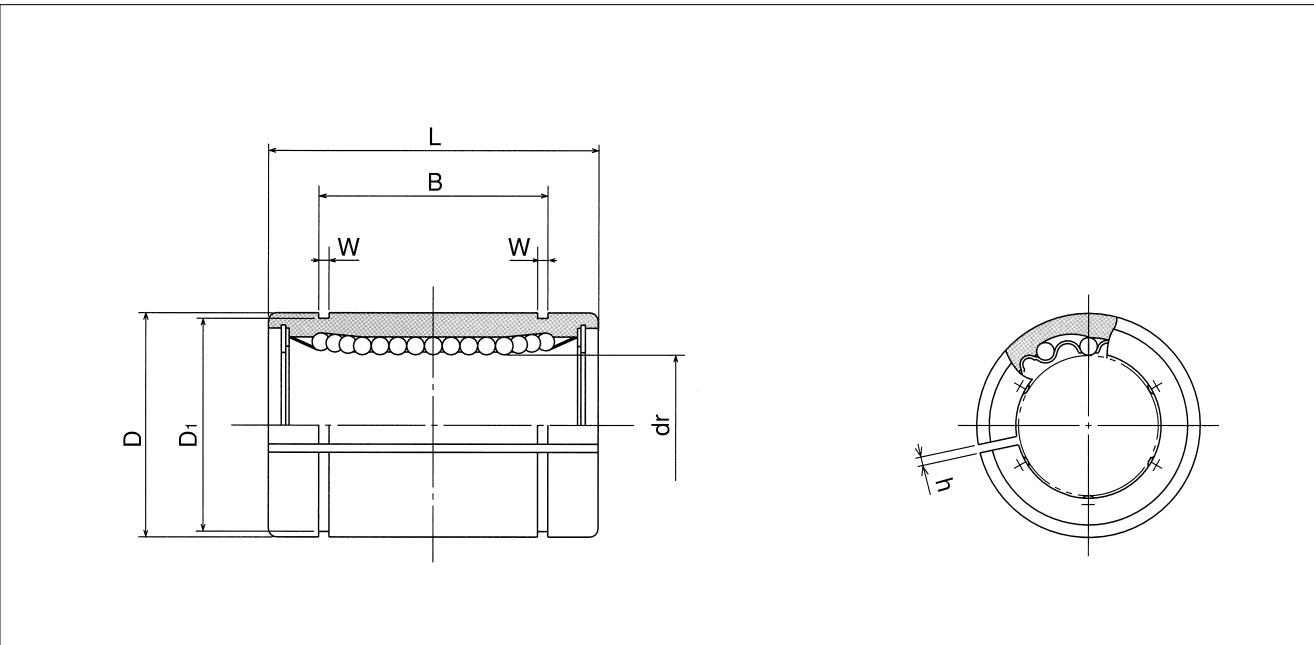

| major dimensions | | | | | | | eccentricity* | basic load rating | | mass g | shaft diameter mm |
|------------------|-----------------|-------|-----------------|------|----------------|-----|---------------|-------------------|----------------|-----------|-------------------------|
| mm | L | mm | B | mm | D ₁ | h | | dynamic | static | | |
| | tolerance mm | | tolerance mm | | | | | C | C ₀ | | |
| 22 | | 14.5 | | 1.1 | 11.5 | 1 | 12 | 206 | 265 | 10 | 5 |
| 25 | | 16.5 | | 1.1 | 15.2 | 1 | | 265 | 402 | 19.5 | 8 |
| 29 | 0 | 22 | 0 | 1.3 | 18 | 1 | | 372 | 549 | 29 | 10 |
| 32 | -0.2 | 22.9 | -0.2 | 1.3 | 21 | 1.5 | | 510 | 784 | 44 | 12 |
| 36 | | 24.9 | | 1.3 | 24.9 | 1.5 | | 578 | 892 | 59 | 16 |
| 45 | | 31.5 | | 1.6 | 30.3 | 2 | 15 | 862 | 1,370 | 100 | 20 |
| 58 | | 44.1 | | 1.85 | 37.5 | 2 | | 980 | 1,570 | 230 | 25 |
| 68 | 0 | 52.1 | 0 | 1.85 | 44.5 | 2 | 17 | 1,570 | 2,740 | 355 | 30 |
| 80 | -0.3 | 60.6 | -0.3 | 2.15 | 59 | 3 | | 2,160 | 4,020 | 758 | 40 |
| 100 | | 77.6 | | 2.65 | 72 | 3 | 20 | 3,820 | 7,940 | 1,230 | 50 |
| 125 | 0 | 101.7 | 0 | 3.15 | 86.5 | 3 | | 4,700 | 9,800 | 2,170 | 60 |
| 165 | -0.4 | 133.7 | -0.4 | 4.15 | 116 | 3 | | 7,350 | 16,000 | 5,000 | 80 |

1N ≅ 0.102kgf



PACIFIC INTERNATIONAL BEARING SALES, INC.
800.228.8895 • WWW.PACIFICBEARINGSALES.COM

KB-OP TYPE

— Open Type —

This type is a metric dimension series generally used in Europe.

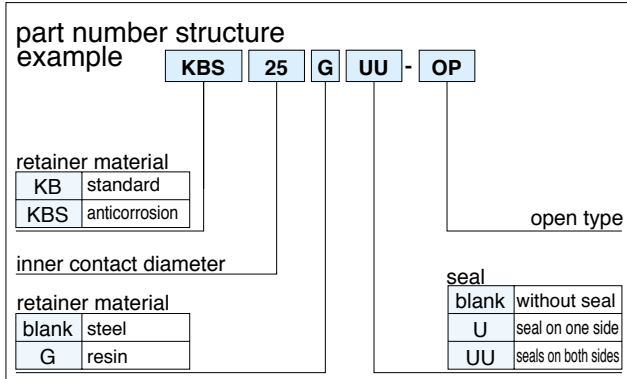
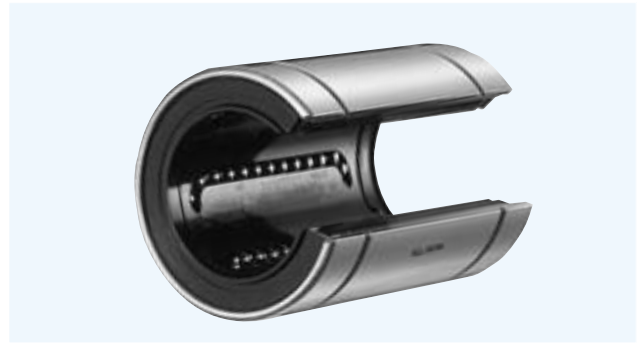

| part number | | | | number of ball circuits | dr | | | |
|----------------|-----------------|--------------------|------------------|-------------------------|----|------------------|-----|------------------|
| standard | | anticorrosion | | | mm | tolerance* μm | D | |
| steel retainer | resin retainer | stainless retainer | resin retainer | | | | mm | tolerance* μm |
| — | KB10G-OP | — | KBS10G-OP | 3 | 10 | + 8 | 19 | 0 |
| KB12-OP | KB12G-OP | KBS12-OP | KBS12G-OP | 3 | 12 | 0 | 22 | - 9 |
| KB16-OP | KB16G-OP | KBS16-OP | KBS16G-OP | 3 | 16 | + 9 | 26 | 0 |
| KB20-OP | KB20G-OP | KBS20-OP | KBS20G-OP | 4 | 20 | - 1 | 32 | - 11 |
| KB25-OP | KB25G-OP | KBS25-OP | KBS25G-OP | 5 | 25 | +11 | 40 | 0 |
| KB30-OP | KB30G-OP | KBS30-OP | KBS30G-OP | 5 | 30 | - 1 | 47 | - 11 |
| KB40-OP | KB40G-OP | KBS40-OP | KBS40G-OP | 5 | 40 | +13 | 62 | 0 |
| KB50-OP | KB50G-OP | KBS50-OP | KBS50G-OP | 5 | 50 | - 2 | 75 | - 13 |
| KB60-OP | KB60G-OP | KBS60-OP | KBS60G-OP | 5 | 60 | | 90 | 0 |
| KB80-OP | — | — | — | 5 | 80 | +16/-4 | 120 | - 15 |

* Accuracy is measured prior to machining open slot.



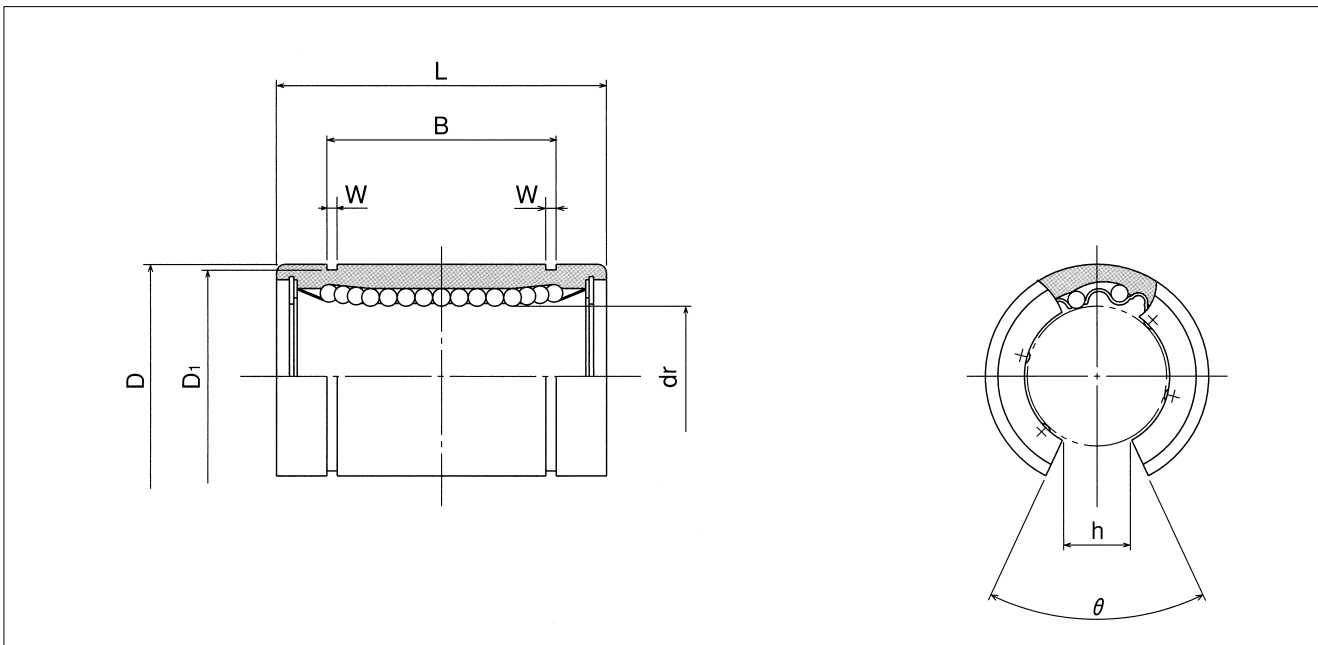

| major dimensions | | | | | | | | eccentricity μm | basic load rating | | mass g | shaft diameter mm |
|------------------|-----------------|-------|-----------------|------|------|------|-----|-------------------------------|-------------------|--------|-----------|-------------------------|
| mm | L | mm | B | mm | mm | mm | mm | | N | N | | |
| | tolerance mm | | tolerance mm | | | | | | | | | |
| 29 | | 22 | | 1.3 | 18 | 6.8 | 80° | 12 | 372 | 549 | 23 | 10 |
| 32 | 0 | 22.9 | 0 | 1.3 | 21 | 7.5 | 78° | | 510 | 784 | 35 | 12 |
| 36 | -0.2 | 24.9 | -0.2 | 1.3 | 24.9 | 10 | 78° | | 578 | 892 | 48 | 16 |
| 45 | | 31.5 | | 1.6 | 30.3 | 10 | 60° | 15 | 862 | 1,370 | 84 | 20 |
| 58 | | 44.1 | | 1.85 | 37.5 | 12.5 | 60° | | 980 | 1,570 | 195 | 25 |
| 68 | 0 | 52.1 | 0 | 1.85 | 44.5 | 12.5 | 50° | | 1,570 | 2,740 | 309 | 30 |
| 80 | -0.3 | 60.6 | -0.3 | 2.15 | 59 | 16.8 | 50° | 17 | 2,160 | 4,020 | 665 | 40 |
| 100 | | 77.6 | | 2.65 | 72 | 21 | 50° | | 3,820 | 7,940 | 1,080 | 50 |
| 125 | 0 | 101.7 | 0 | 3.15 | 86.5 | 27.2 | 54° | 20 | 4,700 | 9,800 | 1,900 | 60 |
| 165 | -0.4 | 133.7 | -0.4 | 4.15 | 116 | 36.3 | 54° | | 7,350 | 16,000 | 4,380 | 80 |

1N \approx 0.102kgf



PACIFIC INTERNATIONAL BEARING SALES, INC.
800.228.8895 • WWW.PACIFICBEARINGSALES.COM

KB-W TYPE

– Double-Wide Type –

This type is a metric dimension series generally used in Europe.

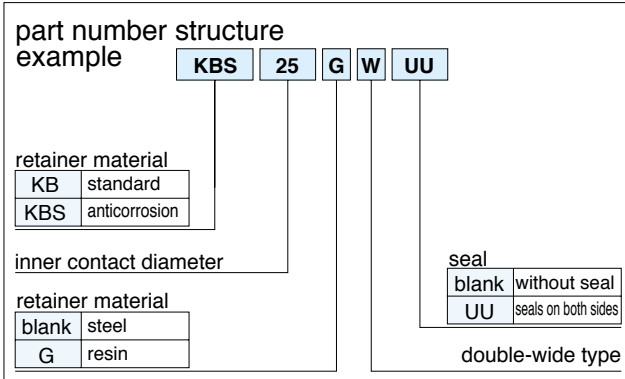
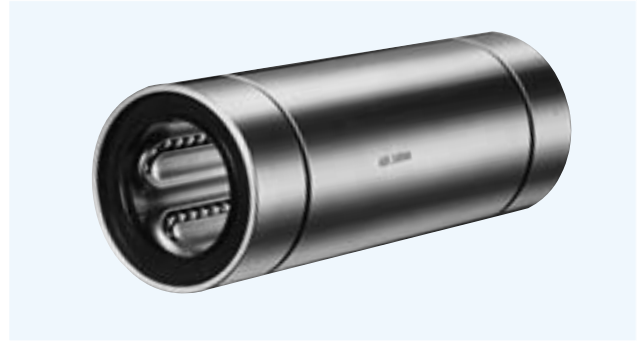

| part number | | | | number of ball circuits | D | | | |
|----------------|----------------|--------------------|----------------|-------------------------|----|-------------------------|----|-------------------------|
| standard | | anticorrosion | | | dr | | D | |
| steel retainer | resin retainer | stainless retainer | resin retainer | | mm | tolerance μm | mm | tolerance μm |
| KB 8W | KB 8GW | KBS 8W | KBS 8GW | 4 | 8 | + 9 | 16 | 0/-9 |
| KB12W | KB12GW | KBS12W | KBS12GW | 4 | 12 | - 1 | 22 | 0 |
| KB16W | KB16GW | KBS16W | KBS16GW | 4 | 16 | +11 | 26 | -11 |
| KB20W | KB20GW | KBS20W | KBS20GW | 5 | 20 | - 1 | 32 | 0 |
| KB25W | KB25GW | KBS25W | KBS25GW | 6 | 25 | +13 | 40 | -13 |
| KB30W | KB30GW | KBS30W | KBS30GW | 6 | 30 | - 2 | 47 | 0 |
| KB40W | KB40GW | KBS40W | KBS40GW | 6 | 40 | +16 | 62 | -15 |
| KB50W | KB50GW | KBS50W | KBS50GW | 6 | 50 | - 4 | 75 | 0/-20 |
| KB60W | KB60GW | KBS60W | KBS60GW | 6 | 60 | | 90 | |



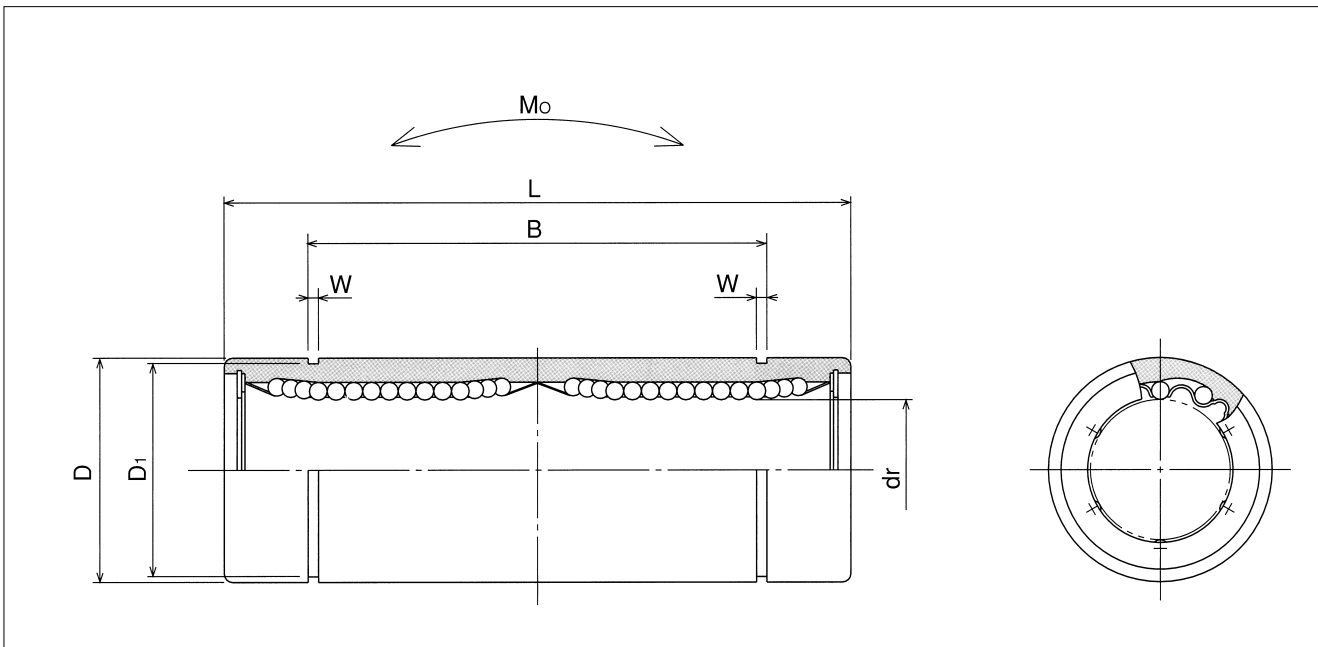

| major dimensions | | | | | | eccentricity | basic load rating | | rated static moment Mo | mass | shaft diameter |
|------------------|-----------------|-------|-----------------|------|----------------|--------------|-------------------|--------|---------------------------|-------|----------------|
| | L | B | | W | D ₁ | | dynamic | static | | | |
| mm | tolerance mm | mm | tolerance mm | mm | mm | μm | C | Co | N · m | g | mm |
| 46 | | 33 | | 1.1 | 15.2 | 15 | 421 | 804 | 4.3 | 40 | 8 |
| 61 | 0 | 45.8 | 0 | 1.3 | 21 | | 813 | 1,570 | 11.7 | 80 | 12 |
| 68 | -0.3 | 49.8 | -0.3 | 1.3 | 24.9 | | 921 | 1,780 | 14.2 | 115 | 16 |
| 80 | | 61 | | 1.6 | 30.5 | 17 | 1,370 | 2,740 | 25.0 | 180 | 20 |
| 112 | | 82 | | 1.85 | 38 | | 1,570 | 3,140 | 44.0 | 430 | 25 |
| 123 | 0 | 104.2 | 0 | 1.85 | 44.5 | | 2,500 | 5,490 | 78.9 | 615 | 30 |
| 151 | -0.4 | 121.2 | -0.4 | 2.15 | 59 | 20 | 3,430 | 8,040 | 147 | 1,400 | 40 |
| 192 | | 155.2 | | 2.65 | 72 | | 6,080 | 15,900 | 396 | 2,320 | 50 |
| 209 | | 170 | | 3.15 | 86.5 | | 7,550 | 20,000 | 487 | 3,920 | 60 |

1N ≅ 0.102kgf 1N·m ≅ 0.102kgf·m