

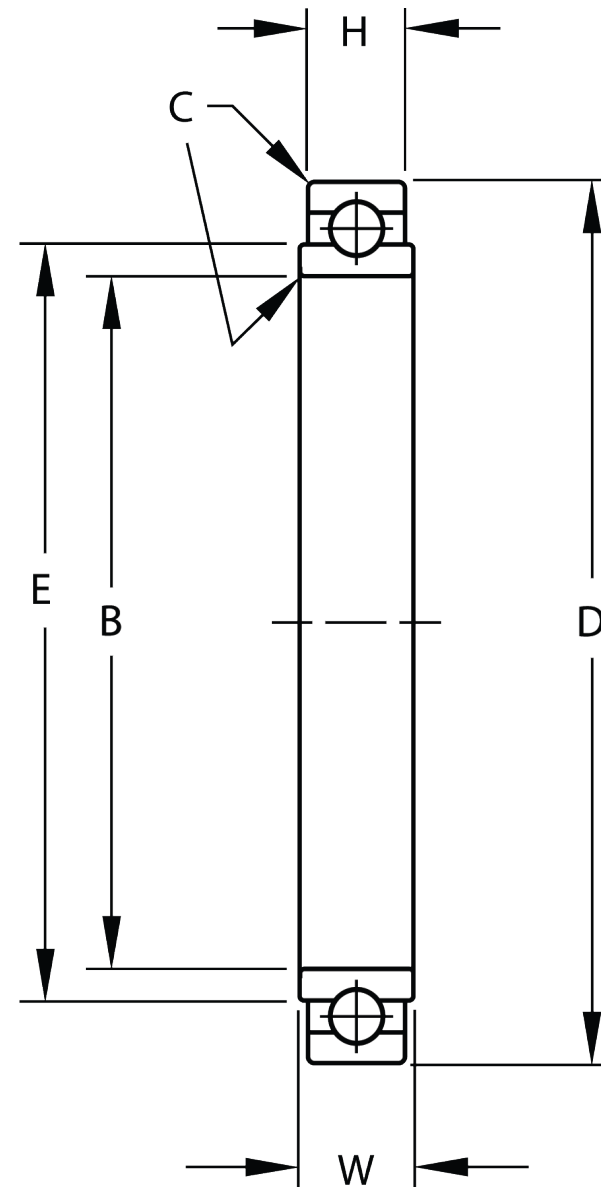

| | |
|-------------------|-----------------------------|
| Width (B) | .2810 in |
| Bore Diameter (d) | .8750 in |
| O.D. (D) | 1.3125 in |
| Brand | RBC |
| Finish | Cadmium |
| Material | 52100 Bearing Quality Steel |



| | |
|-----------|-------------|
| COMPONENT | Torque Tube |
|-----------|-------------|



Pacific International Bearing, Inc.
33258 Central Ave, Union City, CA 94587
1-800-228-8895, 510-512-7000,
info@pibsales.com
www.pibsales.com

This file and any associated information and specifications are provided for reference and evaluation purposes only, and is subject to change without notice. PIB makes no representations, warranties or guarantees as to the appropriateness, accuracy, completeness, or suitability for any purpose, of the file, information or specifications. You are solely responsible for the use of the file, information or specifications.

MB540DDFS428
RBC
.8750in X 1.3125in X .2810in, Precision
Series Torque Tube, Extra Light Duty
Single Row Ball Bearing, Sealed,
Cadmium Plated

| |
|-------|
| UNIT |
| INCH |
| SHEET |