

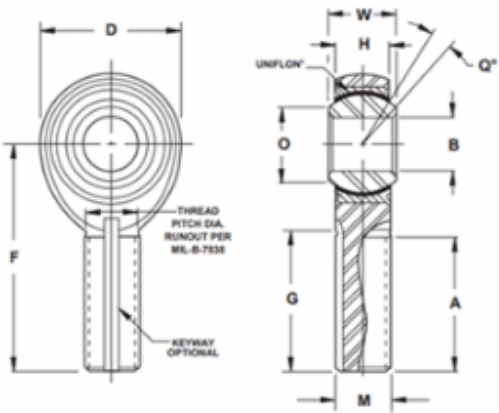

Width (B)	1.3750 in
Contact Angle	12°
Outer Eye Diameter	1.0150 in
Total Length (l2)	5.5125 in
Bore Diameter (d)	1.0000 in
Insert Material	17-4 PH Heat TreatedPTFE
Lubricating Type	Self-Lubricatable
Thread Direction	Left Hand
Thread Type	Male
O.D. (D)	2.7750 in
Brand	RBC



COMPONENT	Male Spherical Plain Rod End
-----------	------------------------------



Pacific International Bearing, Inc.
33258 Central Ave, Union City, CA 94587
1-800-228-8895, 510-512-7000,
info@pibsales.com
www.pibsales.com

This file and any associated information and specifications are provided for reference and evaluation purposes only, and is subject to change without notice. PIB makes no representations, warranties or guarantees as to the appropriateness, accuracy, completeness, or suitability for any purpose, of the file, information or specifications. You are solely responsible for the use of the file, information or specifications.

MTL16
RBC
1.0000in X 2.7750in X 1.3750in, Male
Spherical Plain Rod End,, Military Series,
Self-lubricating, Left-handed Thread

UNIT
Inch
SHEET