

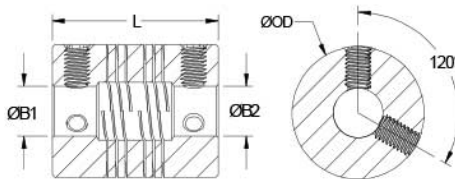

Brand	Ruland
Bore Tolerance	+0.001 in / -0.000 in (+0.025 mm / -0.000 mm)
O.D. (D)	0.590 in (15.0 mm)
Material	303 Stainless Steel
Bore (B1)	0.1250 in
Bore (B2)	3 mm
Keyway	No
B1 Max Shaft Penetration	0.378 in (9.6 mm)
Tariff Code	8483.60.8000
Length (L)	0.787 in (20.0 mm)
Screw Material	Alloy Steel
Screw Finish	Black Oxide
ISO 9001:2015	Certified
REACH	Compliant
RoHS3	Compliant
Conflict Minerals	Compliant
B2 Max Shaft Penetration	0.378 in (9.6 mm)
Number of Screws	4 ea
Forged Set Screw	M3
UNSPC	31163003
Maximum Speed	6000 RPM
Temperature	-40°F to 350°F (-40°C to 176°C)
Country of Origin	USA
Product Group	4 Beam Couplings Set Screw
Shaft Tolerance	+0.0000 in / -0.0005 in +0.000 mm / -0.013 mm
Zero-Backlash?	Yes
Seating Torque	0.92 Nm
Hex Wrench Size	1.5 mm
Static Torque	1.30 Nm
Dynamic Torque Non-Reversing	0.65 Nm
Dynamic Torque Reversing	0.33 Nm
Torsional Stiffness	2.23 Deg/Nm
Angular Misalignment	3.0 deg
Parallel Misalignment	0.20 mm
Axial Motion	0.13 mm



COMPONENT

MW Series Four Beam Coupling



Pacific International Bearing, Inc.
33258 Central Ave, Union City, CA 94587
1-800-228-8895, 510-512-7000,
info@pibsales.com
www.pibsales.com

This file and any associated information and specifications are provided for reference and evaluation purposes only, and is subject to change without notice. PIB makes no representations, warranties or guarantees as to the appropriateness, accuracy, completeness, or suitability for any purpose, of the file, information or specifications. You are solely responsible for the use of the file, information or specifications.

MWS15-1/8"-3MM-SS
Ruland
1/8" X 3mm Bores, 0.590" (15.0mm) Od 0.787" (20.0mm) Length,
Four Beam Coupling, Stainless Steel Set Screw Style

UNIT
Inch/Metric
SHEET