

Brand	Ruland
Screw Material	Alloy Steel
Material	Aluminum
Bore (B1)	0.1250 in
Bore (B2)	3 mm
Keyway	No
B1 Max Shaft Penetration	0.422 in (10.7 mm)
B2 Max Shaft Penetration	0.422 in (10.7 mm)
Number of Screws	2 ea
O.D. (D)	0.750 in (19.1 mm)
Screw Finish	Black Oxide
ISO 9001:2015	Certified
REACH	Compliant
RoHS3	Compliant
Conflict Minerals	Compliant
Tariff Code	8483.60.8000
Bore Tolerance	+0.001 in / -0.000 in (+0.025 mm / -0.000 mm)
Seating Torque	1.21 Nm
UNSPC	31163003
Cap Screw	M2.5
Temperature	-40°F to 225°F (-40°C to 107°C)
Country of Origin	USA
Product Group	P-Series 4 Beam Couplings Clamp
Shaft Tolerance	+0.0000 in / -0.0005 in +0.000 mm / -0.013 mm
Zero-Backlash?	Yes
Balanced Design	Yes
Hex Wrench Size	2.0 mm
Maximum Speed	6000 RPM
Static Torque	26 lb-in (2.94 Nm)
Dynamic Torque Non-Reversing	13 lb-in (1.47 Nm)
Dynamic Torque Reversing	6.5 lb-in (0.74 Nm)
Torsional Stiffness	0.180 Deg/lb-in (1.59 Deg/Nm)
Angular Misalignment	3.0 deg
Parallel Misalignment	0.008 in (0.20 mm)
Axial Motion	0.005 in (0.13 mm)

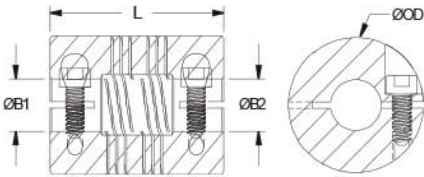

COMPONENT

P-Series Four Beam Coupling



Pacific International Bearing, Inc.
33258 Central Ave, Union City, CA 94587
1-800-228-8895, 510-512-7000,
info@pibsales.com
www.pibsales.com

This file and any associated information and specifications are provided for reference and evaluation purposes only, and is subject to change without notice. PIB makes no representations, warranties or guarantees as to the appropriateness, accuracy, completeness, or suitability for any purpose, of the file, information or specifications. You are solely responsible for the use of the file, information or specifications.

PCR12-1/8"-3MM-A
Ruland
1/8" X 3mm Bores, 0.750" Od, 0.900" Length, Four Beam
Coupling, Aluminum Set Screw Style

UNIT
Inch/Metric
SHEET