

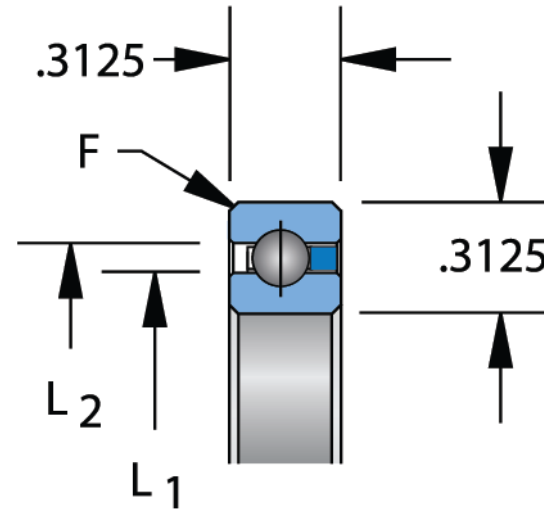

5/32" balls



$$F = .040^4$$

Bearing corners are

Bore Diameter (d)	9.0 in
O.D. (D)	9.6250 in
Width (B)	.3125 in
Brand	KAYDON
Closure	Open
L1	9.2310 in
L2	9.3930 in
Ball Material	Stainless Steel
Ring Material	Stainless Steel

COMPONENT	Thin Section
-----------	--------------



Pacific International Bearing, Inc.
 33258 Central Ave, Union City, CA 94587
 1-800-228-8895, 510-512-7000,
 info@pibsales.com
 www.pibsales.com

This file and any associated information and specifications are provided for reference and evaluation purposes only, and is subject to change without notice. PIB makes no representations, warranties or guarantees as to the appropriateness, accuracy, completeness, or suitability for any purpose, of the file, information or specifications. You are solely responsible for the use of the file, information or specifications.

SB090CP0
KAYDON
 9in X 9.6250in X .3125in, Thin Section
 Bearing, Radial Contact Type-c, Open
 Reali-slim, Stainless Steel

UNIT
Inch
SHEET